

INSTALLATION INSTRUCTIONS



5040115 - 15 Gallon (56.78 L.) Sidekick 2™ Compact Liquid Transfer Tank

For handy transport of flammable, combustible, or nonflammable liquids. A convenient shaker siphon is included. This tank can be installed in any corner of the box on most pickup trucks. However, some trucks may have features that limit where this tank can be installed.

NOTICE: The standard brackets that come with this tank are not compatible with the stock bedrails in a Jeep Gladiator. Please additionally purchase our adaption kit for Jeep Gladiators with bed rails. (PN: 98 0509 0000)

Sidekick Parts List:

	Part Description	Titan PN	Qty
1	Sidekick fuel tank	99 0000 0513	1
2	Fuel cap	98 0000 0195	1
3	Left upper bracket	98 0000 0427	1
4	Right upper bracket	98 0000 0428	1
5	Cradle bracket	98 0000 0429	1
6	Cradle toe clamp	98 0000 0430	1
7	3/8"-16 x 1" Hex Bolt	99 0000 0528	1
7	3/8"-16 x 1.75" Hex Bolt	99 0000 0529	1
7	3/8"-16 x 2.5" Hex Bolt	99 0000 0530	1
7	3/8"-16 x 3.5" Hex Bolt	98 0000 0321	1
8	Foot bumper, rubber	99 0000 0527	1
9	1/2"-13 hex nut	99 0000 0531	1
10	1/2"-13 serrated flange locknut	99 0000 0532	1
11	1/4"-20 plusnut	98 0000 0202	6
12	1/4" washer	99 0000 0719	8
13	1/4"-20 x 1" bolts	01 0000 0157	8
14	Grounding wire	99 0154 0000	1
15	#10-24 x 1/4" screw	99 0000 0540	1

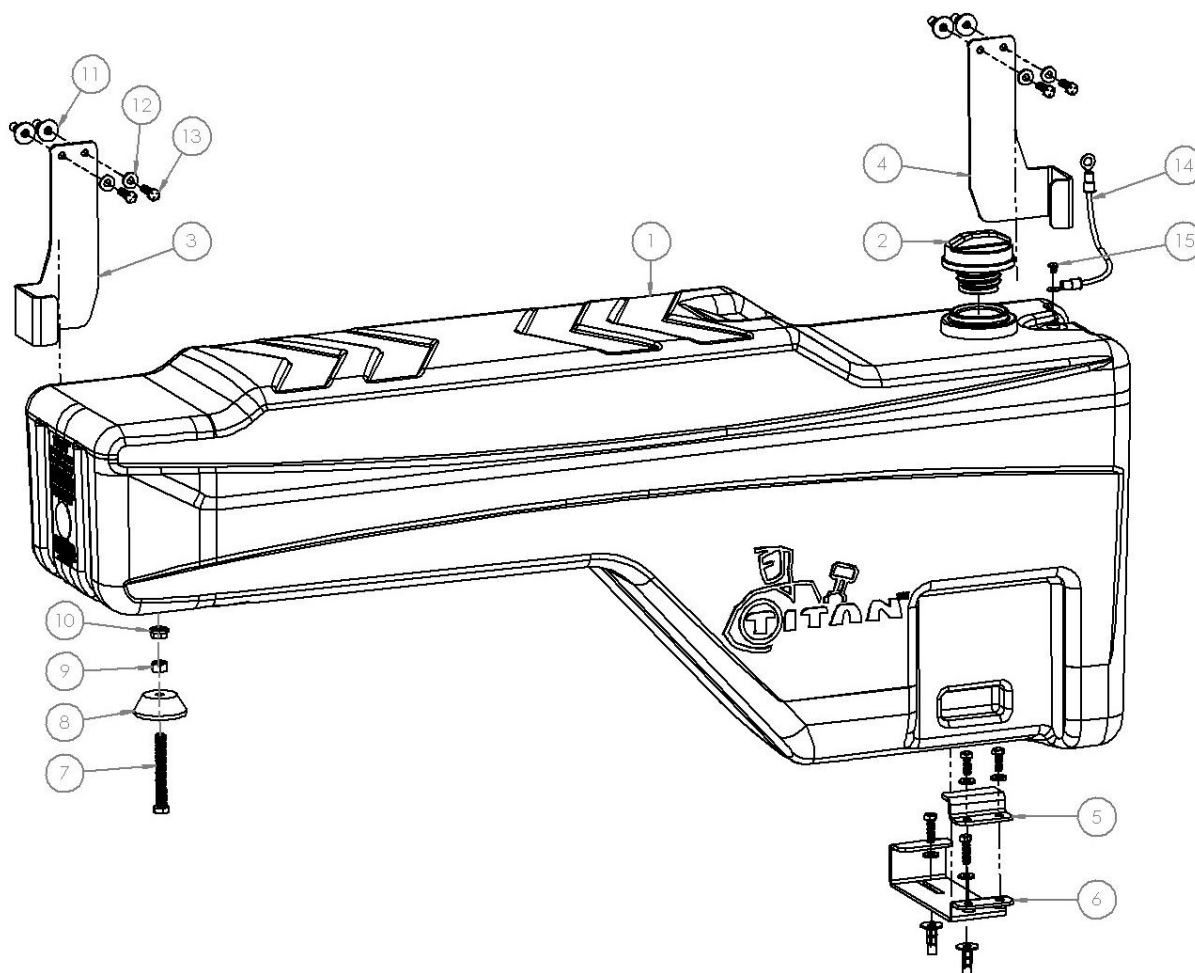

Fig 1: Exploded View of Sidekick Tank and Brackets

Step	Description
1.	Before ANY INSTALLATION BEGINS INVENTORY ALL ITEMS IN KIT. Do not start Installation until you are 100% certain all Items are accounted for.
2.	<p>Place the tank into the bed of the truck in the desired position. Check the position of the tank and the require bracket positions to make sure that there won't be any conflicts. (See the exploded view above to reference the proper bracket positions.)</p> <p>Please Note: Some trucks have cavities in the bed walls that make it look like the tank should fit inside of them. As the upper brackets are typically mounted on the lip that runs around the edge of the bed rail, the side of the tank will typically align with the lip of the bed rail.</p>



3. Using a sharpie or a paint pen, mark the hole locations for the brackets. The cradle bracket at the bottom of the tank has slots to account for different truck bed corrugations, but a spacer may be used to lift up one side of the bracket if necessary. The two upper brackets may mount into a box frame panel or into the lip that runs around the inside of the box frame.



4. Before drilling any holes, check the underneath of the truck to make sure nothing will be damaged. Drill the 6 holes for the brackets with a 3/8" drill bit.
5. In the hardware kit will be a plusnut tool, which looks like a hex nut that wasn't threaded, and a long, partially-threaded screw (either a hex bolt or an Allen Key screw.) Thread the screw through the plusnut tool and into one of the plusnuts. Insert the plusnut into the hole until the flange is flush with the truck. (Gently tap it into place with a mallet if necessary.) Hold the tool in place with a wrench and tighten the screw into the plusnut until it collapses and locks itself into place. Install all 6 plusnuts, as well as the upper brackets and the cradle bracket.

CAUTION: Do NOT overtighten the plusnut, or it will start to spin freely. A spinning plusnut still has excellent pull-out resistance, but it will be very difficult to get the tool screw out and to get the bracket bolt installed.



Fig. 2: As shown above, the plusnut tool has a raised ring on one side. This ring should always be faced towards the plusnut, as it will help the plusnut to seat properly without wandering.

6. Included with the hardware are (4) bolts of various lengths (all marked #7 on the parts list.) Depending on the height of the wheel well, pick the bolt that will keep the top of the tank most level. Thread this bolt through the rubber foot and secure the foot with the 1/2"-13 hex nut. Thread the serrated flange locknut onto the foot, then thread the entire assembly into the bottom of the Sidekick tank. Tighten the serrated flange locknut against the bottom of the tank to lock the foot assembly into place.
7. Inserting the tank into the brackets and locking it into place with the cradle toe clamp.



8. Attach the smaller terminal of the grounding wire to the tank with the small Phillips head screw. Ground the larger terminal to the vehicle. If you have a non-metallic bed, this may require grounding directly to the frame. If you have a metallic bed, you could use one of the upper bracket screws.



NOTE: Fuel cap contains a pressure vent for safety. Overfilling tank may cause cap to vent fuel. Do not overfill.

**Be sure to return the completed warranty registration for your new Titan fuel tank;
or you can register on-line at www.titanfueltanks.com.**

You will find your tank's serial number on the bottom of the tank.

Write your tank's Serial Number here: _____

**A product must be registered within sixty (60) days of receipt for the warranty to be valid. Other conditions
may apply. Consult TITAN's full warranty for details.**

***All capacities are approximate.**

Warranty is void if product is improperly installed.

For questions or customer service call (800) 728-4982

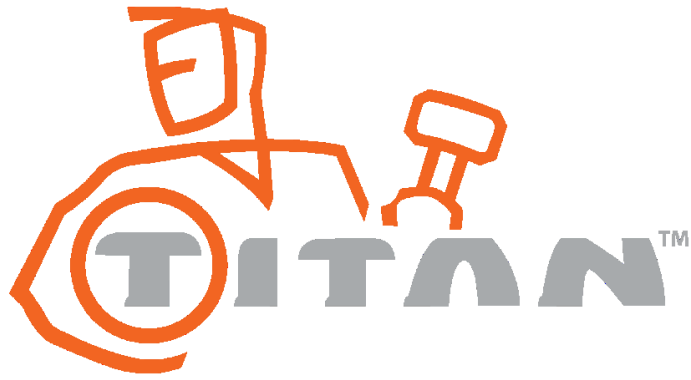

TITAN Fuel Tanks™
P.O. Box 2225
Idaho Falls, ID 83403 USA
Telephone (208) 522-1325, FAX (208) 529-2162
www.titanfueltanks.com

For patent information: <http://titanfueltanks.com/patents>

TITAN Fuel Tanks are PROUDLY MADE IN THE USA!

©2024 Supertanks, LLC
Revised 8/14/24